

- For solid and stranded conductors AWG 27 up to AWG 22
- Max. wire diameter 1.5mm
- Cat.6 performance class EA suitable for 1/10 Gigabit Ethernet
- Temperature range -40°C up to +70°C
- 750 mating cycles

Han 3A adaptor with closed lever:

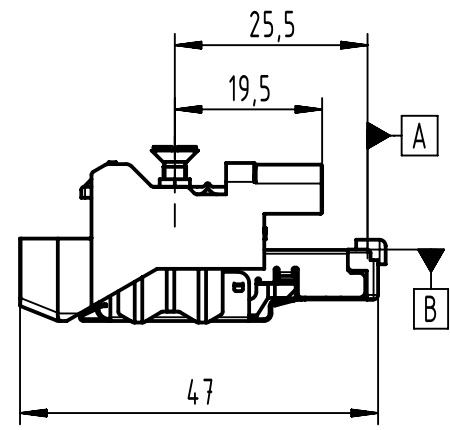

	All rights reserved Department EL PD	All Dimensions in mm Original Size DIN A4		Scale 1:1	Free size tol.		Ref. Sub.	
		Created by SERBANA	Inspected by PREOTU	Standardisation ROEBEN	Date 2022-10-31	State Final Release		
HARTING D-32339 Espelkamp			Title Han3A RJ45 Hybrid 10G insert 8+4p IDC				Doc-Key / ECM-Nr. 100191439/UGD/002/E 500000227324	
		Type TB	Number 09451001760		Rev. E	Page 1/1		